

NEW ZEALAND  
**GEOGRAPHIC**  
EXPEDITIONS

**ISLAND ESCAPE**  
CRUISES

# SEASONS OF ISLAND ESCAPE



**LUXURY CRUISES AND CHARTERS**  
**SHELTERED WATERS, BIG SHIP COMFORT AND EXCEPTIONAL INTIMACY.**



NEW ZEALAND  
**GEOGRAPHIC**  
EXPEDITIONS

**ISLAND ESCAPE**  
CRUISES

---

New Zealand Geographic and Island Escape Cruises have formed an alliance to offer luxury expeditions within New Zealand and Vanuatu. Our shared passion for adventure, discovery and conservation has inspired a series of extraordinary small ship voyages to some of the most remote and fascinating places in New Zealand and the South Seas.

---

The 'Island Passage' is our beautifully-appointed small ship. Weighing in at almost 500 tonnes, she's equipped to travel to inaccessible areas while delivering the highest level of passenger comfort. On board you'll find 10 spacious ensuite cabins, a large dining room and saloon lounge, a library and generous outdoor living spaces. In the galley, our chef works with the freshest local ingredients and delicacies to create memorable meals that reflect the day's adventures.

For entertainment and exploration, Island Passage carries purpose-built landing craft, three large tenders, sea kayaks, a five-seater helicopter and snorkelling equipment. Never a dull moment, although lazing in a deckchair is always an

acceptable option. During each journey, our eight-person crew are on hand to share their knowledge of the ocean and local landscapes. On selected trips, the learning experience will be enhanced by a New Zealand Geographic scientist, historian, photographer or explorer. The NZ Department of Conservation has granted Island Passage permission to operate in DOC sites within New Zealand.

The alliance between Island Escape and New Zealand Geographic is assisting research and exploration projects around the service region. Together we support the New Zealand Geographic Trust with funding for research and conservation in the areas we visit. *Welcome aboard.*









# Spectacular Sounds – November

Once upon a time, many millions of years ago, a mountain range tipped in the sea and the Pacific Ocean flooded into its valleys. And so the Marlborough Sounds were born. This intricate geological sculpture of coves, bays and beaches is one of New Zealand's most magical places. As you can imagine, it's best appreciated from the water.



## Okiwi Bay and French Pass

Island Passage departs mid-afternoon for Okiwi Bay, which is located within beautiful Croisilles Harbour. In 1827 this area was explored by Dumont D'Urville on his ship Astrolabe, who named the harbour after his uncle the Abbot of Croisilles. Daylight saving ensures there will be plenty of time to explore before dinner - catch a tender to the beach or paddle a kayak around the shore. Dinner at seven is your chance to get to know the other guests. Next morning there's time for a refreshing swim before breakfast. Then we'll carefully time our passage through French Pass, because at certain points of the tide the water races through here creating whirlpools and fierce currents. This pass is feared and respected by mariners – D'Urville clipped the reef twice.



## Admiralty Bay and D'Urville Island

Beyond French Pass lies Admiralty Bay – a great place for wildlife watching. We'll anchor here for the night, so that you can explore the area in kayak or tender. Look for king shags, blue penguins, gannets, white-fronted terns, molly hawks, petrels and shearwaters. With any luck you'll also see fur seals and dolphins – maybe even an orca or two. The next day is devoted to D'Urville Island. Here the predator-free forest is alive with tui, bellbirds, native robins, weka and kaka. Follow the walking tracks to discover waterfalls, river pools and huge views. After a magnificent dinner, hosted by the captain, take your favourite night cap to a steamer chair and enjoy the night sounds of this magical place.



## Home to Nelson

There'll be time for a final morning swim or kayak before Island Passage raises her anchor and begins the journey across Tasman Bay to Nelson. Watch for dolphins and orca while you enjoy glorious views of the coast and Tasman Sea. You'll disembark at 11am.





# Island Passage – your relaxing home on the water

The 'Island Passage' is perfect for a leisurely break from a hectic lifestyle. We only have accommodation onboard for 20 passengers. The ten spacious cabins, with rich timber panelling and New Zealand Kauri furniture, all fitted with DVD, audio and TV, and are all air-conditioned. Most with doors opening on to the outer deck, each cabin has its own private ensuite.



## Bridge Deck Suites

Offering the best views on the ship, the two Bridge Deck cabins open directly onto the teak bridge deck. Each cabin is individually air-conditioned with SKY TV, DVD/CD, movies on demand, writing desk, easy chair, super king bed and extra-large bathroom.



## Staterooms

On the same level as the saloon, bar and dining room, the Staterooms have large picture windows and doors opening directly onto the promenade deck. Each cabin has individual air-conditioning, TV, DVD/CD, movies, writing desk and either queen or twin single beds.



## Expedition Cabins

Located on the main deck, our Expedition cabins give you a choice of a queen-size bed or two singles. Suites with single beds have a pullman berth for a third guest. Individual air conditioning, TV, DVD/CD, movies. Sea view from the portholes.



# Vessel Specifications

The 'Island Passage' operates with a crew of eight and is registered as a New Zealand vessel under NZ Safe Ship Management. She has a tonnage of 496 GRT. The ship carries a selection of landing craft, tenders and kayaks to allow exploring off the ship into bays, estuaries and islands. The helicopter is available for trips beyond the range of our sea craft.

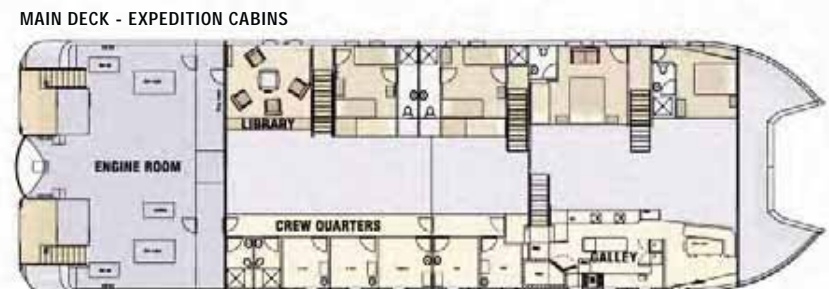
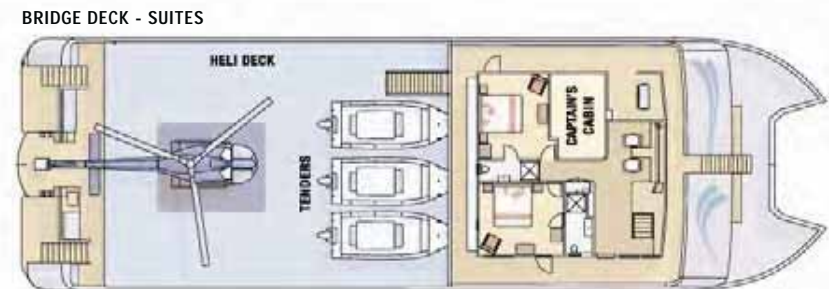

## FACT FILE

### VESSEL SPECIFICATIONS

Length: 42 metres (138 feet)  
 Beam: 12.8 metres (39 feet)  
 Gross weight: 496 tonne  
 Range: 5500 nautical miles  
 Engines: 2 x Kelvin Marine Diesel: 48,000 litres  
 Fresh water: 40,000 litres  
 Desalinator: 5000 litres/day  
 Auto pilot: Cetrek  
 Radar: Northstar x 2

### Onboard equipment

1 x 7-metre landing craft  
 2 x 7-metre sports boats  
 SOLAS rescue boat  
 4.2 metre tender  
 AS355 F1 Squirrel helicopter

Air conditioning: Cruisair  
 Satellite TV: SeaTel 2498SE  
 Home theatre: Bose  
 Televisions: Philips plasma

# Island Passage – onboard hospitality

Relaxation, exceptional food and fine wine are an essential part of your expedition. Fresh air not only clears your mind, it makes you hungry.

Island Passage is equipped with a professional galley and a chef who's dedicated to making every meal magnificent. Local seafood (maybe even some you caught yourself) is often on the menu; you'll also enjoy other delicacies and organic artisan foods produced in the local region.

Breakfast and lunch are usually served on the aft deck, so that you won't miss a single minute of any of the beautiful scenery. In the evening you'll dine in style at one of the 10-seater tables. Conversation is invariably lively and lots of fun.

Our on-board wine cellar is brimming with a selection of award-winning New Zealand wines. You won't need to remember the recipe for your favourite aperitif; our bartender is well-versed in the magic of mixology.







NEW ZEALAND  
**GEOGRAPHIC**  
EXPEDITIONS

[www.expeditions.org.nz](http://www.expeditions.org.nz)

**ISLAND ESCAPE**  
CRUISES

[www.islandescape.co.nz](http://www.islandescape.co.nz)

TRAVEL AGENT