

NEW ZEALAND
GEOGRAPHIC
EXPEDITIONS

ISLAND ESCAPE
CRUISES

SEASONS OF ISLAND ESCAPE



LUXURY CRUISES AND CHARTERS
SHELTERED WATERS, BIG SHIP COMFORT AND EXCEPTIONAL INTIMACY.



NEW ZEALAND
GEOGRAPHIC
EXPEDITIONS

ISLAND ESCAPE
CRUISES

New Zealand Geographic and Island Escape Cruises have formed an alliance to offer luxury expeditions within New Zealand and Vanuatu. Our shared passion for adventure, discovery and conservation has inspired a series of extraordinary small ship voyages to some of the most remote and fascinating places in New Zealand and the South Seas.

The 'Island Passage' is our beautifully-appointed small ship. Weighing in at almost 500 tonnes, she's equipped to travel to inaccessible areas while delivering the highest level of passenger comfort. On board you'll find 10 spacious ensuite cabins, a large dining room and saloon lounge, a library and generous outdoor living spaces. In the galley, our chef works with the freshest local ingredients and delicacies to create memorable meals that reflect the day's adventures.

For entertainment and exploration, Island Passage carries purpose-built landing craft, three large tenders, sea kayaks, a five-seater helicopter and snorkelling equipment. Never a dull moment, although lazing in a deckchair is always an

acceptable option. During each journey, our eight-person crew are on hand to share their knowledge of the ocean and local landscapes. On selected trips, the learning experience will be enhanced by a New Zealand Geographic scientist, historian, photographer or explorer. The NZ Department of Conservation has granted Island Passage permission to operate in DOC sites within New Zealand.

The alliance between Island Escape and New Zealand Geographic is assisting research and exploration projects around the service region. Together we support the New Zealand Geographic Trust with funding for research and conservation in the areas we visit. *Welcome aboard.*



Bay of Islands – January to February



In a 2006 study, the Bay of Islands was found to have the second bluest sky in the world, after Rio de Janeiro.
Dumé, Belle (2 August 2006)



Opua to Assassination Cove

Island Passage departs the port town of Opua at 3pm. We'll cruise up the Veronica Channel, past the historic settlement of Russell and around Tapeka Point before entering the maritime paradise known as the Bay of Islands. Our first anchorage is Te Hue Bay, which also goes by the name of Assassination Cove.

Assassination Cove

French explorer Marion du Fresne and 26 of his crew were killed and eaten in this bay – an act of utu (revenge) by the local tribe. The Frenchmen had made the mistake of fishing in tapu waters, even though they had been warned to stay away. You can relax - the tapu as long-since been lifted from Te Hue Bay.



Assassination Cove to Cooks Cove

After a sumptuous breakfast on deck, make yourself comfortable for the passage to Motuarohia Island, where we'll anchor in Cooks Cove. In the Maori language, Motuarohia means 'island to be desired'. You'll quickly see why. From here, we can guide your explorations of this fabulous island and nearby Urupukapuka.

Urupukapuka Island

The largest island in the bay, Urupukapuka has eight significant terraced pa (fortified village) sites, which you can discover on an archaeological walk that's interpreted with signs. Located mostly on headlands, the pa allowed Maori to see enemies approaching by sea.









Island Passage – your relaxing home on the water

The 'Island Passage' is perfect for a leisurely break from a hectic lifestyle. We only have accommodation onboard for 20 passengers. The ten spacious cabins, with rich timber panelling and New Zealand Kauri furniture, all fitted with DVD, audio and TV, and are all air-conditioned. Most with doors opening on to the outer deck, each cabin has its own private ensuite.



Bridge Deck Suites

Offering the best views on the ship, the two Bridge Deck cabins open directly onto the teak bridge deck. Each cabin is individually air-conditioned with SKY TV, DVD/CD, movies on demand, writing desk, easy chair, super king bed and extra-large bathroom.



Staterooms

On the same level as the saloon, bar and dining room, the Staterooms have large picture windows and doors opening directly onto the promenade deck. Each cabin has individual air-conditioning, TV, DVD/CD, movies, writing desk and either queen or twin single beds.



Expedition Cabins

Located on the main deck, our Expedition cabins give you a choice of a queen-size bed or two singles. Suites with single beds have a pullman berth for a third guest. Individual air conditioning, TV, DVD/CD, movies. Sea view from the portholes.



Vessel Specifications

The 'Island Passage' operates with a crew of eight and is registered as a New Zealand vessel under NZ Safe Ship Management. She has a tonnage of 496 GRT. The ship carries a selection of landing craft, tenders and kayaks to allow exploring off the ship into bays, estuaries and islands. The helicopter is available for trips beyond the range of our sea craft.

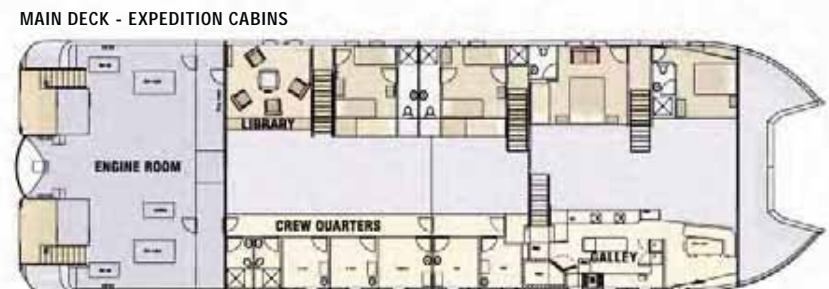
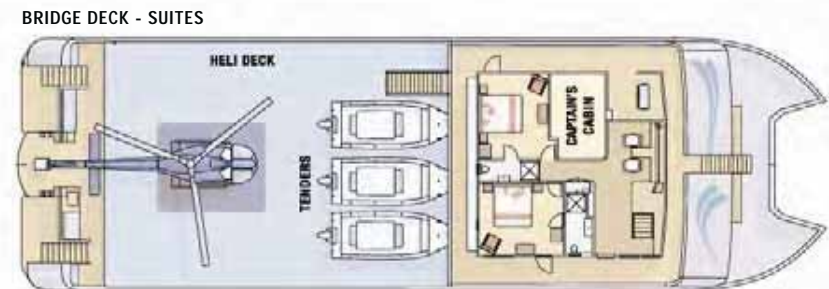

FACT FILE

VESSEL SPECIFICATIONS

Length: 42 metres (138 feet)
Beam: 12.8 metres (39 feet)
Gross weight: 496 tonne
Range: 5500 nautical miles
Engines: 2 x Kelvin Marine Diesel: 48,000 litres
Fresh water: 40,000 litres
Desalinator: 5000 litres/day
Auto pilot: Cetrek
Radar: Northstar x 2

Onboard equipment

1 x 7-metre landing craft
2 x 7-metre sports boats
SOLAS rescue boat
4.2 metre tender
AS355 F1 Squirrel helicopter

Air conditioning: Cruisair
Satellite TV: SeaTel 2498SE
Home theatre: Bose
Televisions: Philips plasma

Island Passage – onboard hospitality

Relaxation, exceptional food and fine wine are an essential part of your expedition. Fresh air not only clears your mind, it makes you hungry.

Island Passage is equipped with a professional galley and a chef who's dedicated to making every meal magnificent. Local seafood (maybe even some you caught yourself) is often on the menu; you'll also enjoy other delicacies and organic artisan foods produced in the local region.

Breakfast and lunch are usually served on the aft deck, so that you won't miss a single minute of any of the beautiful scenery. In the evening you'll dine in style at one of the 10-seater tables. Conversation is invariably lively and lots of fun.

Our on-board wine cellar is brimming with a selection of award-winning New Zealand wines. You won't need to remember the recipe for your favourite aperitif; our bartender is well-versed in the magic of mixology.







NEW ZEALAND
GEOGRAPHIC
EXPEDITIONS

www.expeditions.org.nz

ISLAND ESCAPE
CRUISES

www.islandescape.co.nz

TRAVEL AGENT