

NEW ZEALAND  
**GEOGRAPHIC**  
EXPEDITIONS

**ISLAND ESCAPE**  
CRUISES

# SEASONS OF ISLAND ESCAPE



**LUXURY CRUISES AND CHARTERS**  
**SHELTERED WATERS, BIG SHIP COMFORT AND EXCEPTIONAL INTIMACY.**



NEW ZEALAND  
**GEOGRAPHIC**  
EXPEDITIONS

**ISLAND ESCAPE**  
CRUISES

---

New Zealand Geographic and Island Escape Cruises have formed an alliance to offer luxury expeditions within New Zealand and Vanuatu. Our shared passion for adventure, discovery and conservation has inspired a series of extraordinary small ship voyages to some of the most remote and fascinating places in New Zealand and the South Seas.

---

The 'Island Passage' is our beautifully-appointed small ship. Weighing in at almost 500 tonnes, she's equipped to travel to inaccessible areas while delivering the highest level of passenger comfort. On board you'll find 10 spacious ensuite cabins, a large dining room and saloon lounge, a library and generous outdoor living spaces. In the galley, our chef works with the freshest local ingredients and delicacies to create memorable meals that reflect the day's adventures.

For entertainment and exploration, Island Passage carries purpose-built landing craft, three large tenders, sea kayaks, a five-seater helicopter and snorkelling equipment. Never a dull moment, although lazing in a deckchair is always an

acceptable option. During each journey, our eight-person crew are on hand to share their knowledge of the ocean and local landscapes. On selected trips, the learning experience will be enhanced by a New Zealand Geographic scientist, historian, photographer or explorer. The NZ Department of Conservation has granted Island Passage permission to operate in DOC sites within New Zealand.

The alliance between Island Escape and New Zealand Geographic is assisting research and exploration projects around the service region. Together we support the New Zealand Geographic Trust with funding for research and conservation in the areas we visit. *Welcome aboard.*







# Awesome Abel Tasman – November

Small but exquisitely formed, the Abel Tasman National Park is a paradise of golden beaches, granite and marble rock formations, lush native forest and remarkable wildlife encounters. Close to the shore, the water is a tropical shade of turquoise and so clear that you can watch the anchor dig into the sand. Apart from the walking track that traces the park's boundary with the sea, there's not a road to be seen.



## First night – Awaroa

After boarding Island Passage mid-afternoon, you can sit on deck with a cool drink and watch the Abel Tasman panorama slide by. Hills cloaked in native forest slope down to a procession of perfect beaches. Between the main bays, granite and marble boulders mark the boundary between forest and ocean. We'll pass the Tonga Island fur seal colony and the secret inlet of Shag Harbour before arriving in beautiful Awaroa Bay, our anchorage for the night. While the barman supplies your favourite aperitifs, chef is preparing a gourmet meal that promises to be as outstanding as the scenery.



## Farewell Spit and Onetahuti Bay

Towards sunrise, the ship will move quietly to Tarakohe Harbour, so you'll wake to enjoy Golden Bay views with your breakfast. Today's main event is a safari to Farewell Spit, which is home to more than 90 bird species. Over summer you can see migratory birds from the northern hemisphere – bar tailed godwits, knots, curlews, whimbrels and turnstones.

You'll explore the historic buildings at the century-old lighthouse and stop at Fossil Point, where fossilised shells and wormcasts are emerging from the mudstone cliffs. Back at the ship, we move to Onetahuti Bay for the evening.



## And on to Anchorage

Today you'll experience two of the greatest pleasures of the Abel Tasman – sea kayaking and hiking. From Onetahuti you'll paddle to the fur seal colony at Tonga Island; delightful encounters with the residents are a certainty. Then you'll head south, along the granite and forest coastline to beautiful Bark Bay. Watch for little blue penguins along the way. Here you'll take to the coastal walkway for a two-hour hike to Anchorage, where the ship awaits.

Highlights include the swing bridge at Falls River and native birdsong in the forest. If the tide's out, you'll get to take off your shoes and cross the Torrent Bay estuary the quick-but-muddy way. Tonight the Captain hosts a farewell dinner under the stars. Next morning, Island Passage crosses Tasman Bay to Nelson, where you'll disembark at 11am.



ABEL TASMAN NATIONAL PARK

NELSON





# Island Passage – your relaxing home on the water

The 'Island Passage' is perfect for a leisurely break from a hectic lifestyle. We only have accommodation onboard for 20 passengers. The ten spacious cabins, with rich timber panelling and New Zealand Kauri furniture, all fitted with DVD, audio and TV, and are all air-conditioned. Most with doors opening on to the outer deck, each cabin has its own private ensuite.



## Bridge Deck Suites

Offering the best views on the ship, the two Bridge Deck cabins open directly onto the teak bridge deck. Each cabin is individually air-conditioned with SKY TV, DVD/CD, movies on demand, writing desk, easy chair, super king bed and extra-large bathroom.



## Staterooms

On the same level as the saloon, bar and dining room, the Staterooms have large picture windows and doors opening directly onto the promenade deck. Each cabin has individual air-conditioning, TV, DVD/CD, movies, writing desk and either queen or twin single beds.



## Expedition Cabins

Located on the main deck, our Expedition cabins give you a choice of a queen-size bed or two singles. Suites with single beds have a pullman berth for a third guest. Individual air conditioning, TV, DVD/CD, movies. Sea view from the portholes.



# Vessel Specifications

The 'Island Passage' operates with a crew of eight and is registered as a New Zealand vessel under NZ Safe Ship Management. She has a tonnage of 496 GRT. The ship carries a selection of landing craft, tenders and kayaks to allow exploring off the ship into bays, estuaries and islands. The helicopter is available for trips beyond the range of our sea craft.

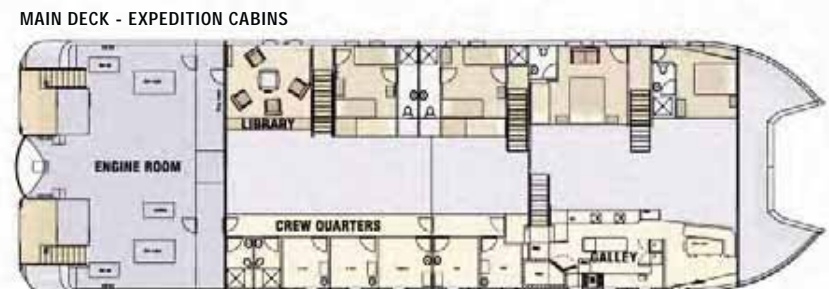
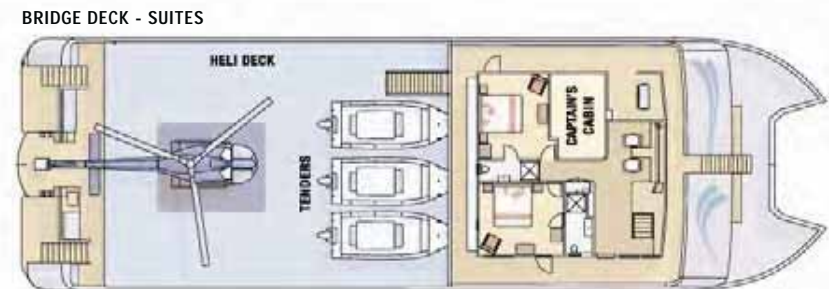

## FACT FILE

### VESSEL SPECIFICATIONS

Length: 42 metres (138 feet)  
Beam: 12.8 metres (39 feet)  
Gross weight: 496 tonne  
Range: 5500 nautical miles  
Engines: 2 x Kelvin Marine Diesel: 48,000 litres  
Fresh water: 40,000 litres  
Desalinator: 5000 litres/day  
Auto pilot: Cetrek  
Radar: Northstar x 2

### Onboard equipment

1 x 7-metre landing craft  
2 x 7-metre sports boats  
SOLAS rescue boat  
4.2 metre tender  
AS355 F1 Squirrel helicopter

Air conditioning: Cruisair  
Satellite TV: SeaTel 2498SE  
Home theatre: Bose  
Televisions: Philips plasma

# Island Passage – onboard hospitality

Relaxation, exceptional food and fine wine are an essential part of your expedition. Fresh air not only clears your mind, it makes you hungry.

Island Passage is equipped with a professional galley and a chef who's dedicated to making every meal magnificent. Local seafood (maybe even some you caught yourself) is often on the menu; you'll also enjoy other delicacies and organic artisan foods produced in the local region.

Breakfast and lunch are usually served on the aft deck, so that you won't miss a single minute of any of the beautiful scenery. In the evening you'll dine in style at one of the 10-seater tables. Conversation is invariably lively and lots of fun.

Our on-board wine cellar is brimming with a selection of award-winning New Zealand wines. You won't need to remember the recipe for your favourite aperitif; our bartender is well-versed in the magic of mixology.







NEW ZEALAND  
**GEOGRAPHIC**  
EXPEDITIONS

[www.expeditions.org.nz](http://www.expeditions.org.nz)

**ISLAND ESCAPE**  
CRUISES

[www.islandescape.co.nz](http://www.islandescape.co.nz)

TRAVEL AGENT